

**SNTOOM<sup>®</sup>**



Audible & Visual Alarm  
Explosion-proof Audible & Visual Alarm  
Motor Siren  
Electric Sirens  
Explosion-proof Electric Sirens  
Hand-crank Siren

**ZHEJIANG SHUNTONG ELECTRIC CO.,LTD.**

Address: Upstream Industrial Zone, Liushi City, Yueqing City, Zhejiang Province

Tel: 86-577-61721053

Fax: 86-577-56848069

Site: shuntong.mg-w.cn

Email: 2850382030@qq.com

**2021**

**SHUNTONG ELECTRIC CO., LTD**



# Enterprise Introduction

Zhejiang Shuntong Electric Co.,Ltd. is a professional manufacturer specializing in R & D, production and sales. The company has passed ISO9001: 2000 quality management system standard requirements certification. Specializing in industrial alarm, communication, lighting, aviation warning etc. Independently developed products are widely used in iron and steel metallurgy, telecommunications towers, lifting machinery, engineering machinery, ports and terminals, transportation, wind power generation, and ocean shipping. The company now has more than 20 professional and technical personnel, becoming one of the professional suppliers in this field, and has won wide recognition from customers.

Let everyone work safely, and let their families and people around them live a healthy life , provide safety warnings and security for people in high-risk areas of work, committed to R & D, design and manufacture of high-reliability industrial alarms, industrial lamps, industrial communication, industrial sensing, personal protection and other products.

Only if we master the most precise engineering technology can we provide the highest quality products and let everyone work in a safe environment. Taking the task of "providing safety warnings for heavy industry, steel, mining, ports and terminals, wind power and other fields", we believe that our products play a vital role for workers all over the world.

The company follows the market-oriented, customer-centric, and integrity-based principles to ensure quality and cost reduction, improve management and efficiency, and to benefit customers with low prices and good quality. The company will wholeheartedly provide users with quality products and satisfactory services. Is willing to work with our customers to build the "Shuntong" brand and create a brilliant tomorrow.





# Contents

|  |       |                            |       |
|--|-------|----------------------------|-------|
| Audible & Visual Alarm                 | 1-16  | Hand-crank siren           | 30-32 |
| Explosion-proof Audible & Visual Alarm | 17-21 | Electronic buzzer/ Horn    | 33-37 |
| Motor Siren                            | 22-24 | Strobe Light Series        | 38-41 |
| Electric sirens                        | 25-27 | Rotating Warning Light     | 42-46 |
| Explosion-proof electric sirens        | 28-29 | Flash Warning Light Series | 47-50 |

## AUDIBLE & VISUAL ALARM

### Product Introduction

Audible and visual alarm is a kind of alarm signal device used in dangerous places to send out warning signals to people through sound and lights. When an emergency situation such as an accident or fire occurs at the production site, the control signal sent by alarm controller activates the alarm circuit to send out sound and light alarm signals to complete the alarm purpose. The alarm shell is made of stainless steel, the lamp shell has strong impact resistance, 180° clearly visible super bright LED light-emitting tube, equipped with super buzzer, stable work, long service life, low power consumption, and not affected by pollutants and water.

### Application field

Iron and steel metallurgy, telecommunications towers, cranes, construction machinery, ports, transportation, wind power, ocean-going ships etc.



### Installation Matters

- (1) The installation height of the alarm should be above 180cm for the maintenance personnel to carry out daily maintenance.
- (2) The alarm is a safety instrument with sound and light display functions. It should be installed in a place where personnel can easily see and hear.
- (3) No strong electromagnetic fields (such as high-power motors, transformers) around the alarm.
- (4) Cut off the power before installation to prevent burn out alarm.
- (5) Check whether the power supply is consistent with the rated voltage of the alarm.
- (6) Make sure the wiring is accurate before turning on the power (DC should be distinguished between positive and negative).
- (7) Ensure the alarm is well grounded.
- (8) When installing, the warning light should face upwards and use expansion screws for wall mounting.



### Maintenance

- (1) Regularly check the performance of the sound and light alarm when in use. If damaged, it should be repaired by professionals.
- (2) Clean the dust regularly and check the working status.
- (3) When the temperature is low, drip some lubricating oil on the rotating part.



### Operation & Use instructions

**Wiring:** The audible and visual alarm is a two-wire connection.

Brown / Red ----- Live wire / +

Blue / Black ----- Neutral wire / -

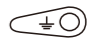
According to the working voltage provided by the real object, the red color of DC is "+", the black is "-", and the positive and negative poles of AC are not divided. Working mode: power on, the horn sounds, and the warning light flashes. Grounding: There is a "  " grounding sheet at the bottom of the sound and light alarm. Use solder wire to weld the ground wire and the ground sheet to ensure that the sound and light alarm is well grounded. Or use a grounding wire to wind and fix the screw of the grounding plate, and then tighten the screw of the grounding plate to ensure that the sound and light alarm is well grounded.

## STSG-01

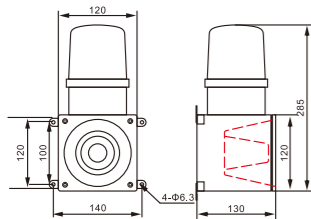

### Functions and features

1. With volume and type adjustment switch, simple to use, continuous work for a long time.
2. Special integrated chip design, super electromagnet anti-interference performance.
3. The inner core of the flash lamp is an LED tube, which is made of the characteristics of a single-chip microcomputer. The number of flashes per second can be determined according to customer requirements.
4. The shell is made of aluminum alloy die-casting, which can effectively resist salt spray corrosion and has good waterproof, moisture-proof and shock-proof functions.
5. Conventional 3 kinds of alarm sounds, siren sound, fire sound, and ambulance sound. The sound can be customized.

### Parameters

|   |                                |                  |                       |
|---|--------------------------------|------------------|-----------------------|
| Model   | STSG-01                        | Frequency        | 50/60Hz               |
| Work humidity   | -30℃~+70℃                      | Protection grade | IP56                  |
| Net weight  | 1.6kg                          | Voltage          | DC12V/24V AC220V/380V |
| Decibel   | 106~120dB                      | Color(Lamp)      | Red Yellow Blue Green |
| Dimension   | 140(L) × 130(W) × 285(H)mm     |                  |                       |
| Material  | Shade: Aluminum alloy Lamp: PC |                  |                       |
| Application field: Suitable for large and medium-sized cranes and ship terminal conveying equipment in port machinery and electromechanical industries. |                                |                  |                       |

## STSG-03

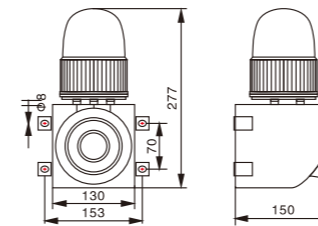

### Functions and features

1. Simple to use, continuous work for a long time.
2. Special integrated chip design, super electromagnetic anti-interference performance.
3. The inner core of the flash lamp is an LED tube, which has a long service life.
4. The shell is made of aluminum alloy die-casting, which can effectively resist salt spray corrosion and has good waterproof, moisture-proof and shock-proof functions.

### Parameters

|               |   |                  |                                |
|---------------|---|------------------|--------------------------------|
| Model         | STSG-03                                     | Frequency        | 50/60Hz                        |
| Work humidity | -30℃~+70℃                                   | Protection grade | IP56                           |
| Net weight    | 2.3kg                                       | Voltage          | DC12V/24V AC220V/380V          |
| Decibel       | 106~120dB                                   | Color(Lamp)      | Red Yellow Blue Green          |
| Current       | 125A  | Dimension        | 187(L) × 191(W) × 310(H)mm     |
| Power         | 10~25W                                      | Material         | Shade: Aluminum alloy Lamp: PC |
| Tone          | Siren sound, other tones can be customized. |                  |                                |

Application field: Suitable for large and medium-sized cranes and ship terminal conveying equipment in port machinery and electromechanical industries.

## STSG-02

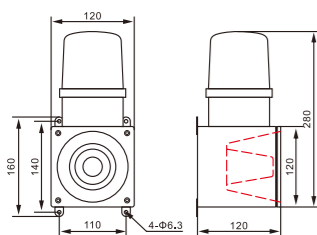

### Functions and features

1. With volume and type adjustment switch, simple to use, continuous work for a long time.
2. Special integrated chip design, super electromagnetic anti-interference performance.
3. The inner core of the flash lamp is an LED tube, service life exceeds 100,000 hours.
4. The shell is made of aluminum alloy die-casting, which can effectively resist salt spray corrosion and has good waterproof, moisture-proof and shock-proof functions.
5. Conventional 3 kinds of alarm sounds, siren sound, fire sound, and ambulance sound. The sound can be customized.

### Parameters

|   |   |                  |                       |
|---|---|------------------|-----------------------|
| Model   | STSG-02                                     | Frequency        | 50/60Hz               |
| Work humidity   | -30℃~+70℃                                   | Protection grade | IP56                  |
| Net weight  | 2.5kg                                       | Voltage          | DC12V/24V AC220V/380V |
| Decibel   | 106~120dB                                   | Color(Lamp)      | Red Yellow Blue Green |
| Dimension   | 120(L) × 210(W) × 285(H)mm                  |                  |                       |
| Material  | Shade: Aluminum alloy Lamp: PC Speaker: ABS |                  |                       |
| Application field: Suitable for large and medium-sized cranes and ship terminal conveying equipment in port machinery and electromechanical industries. |   |                  |                       |

## STSG-05

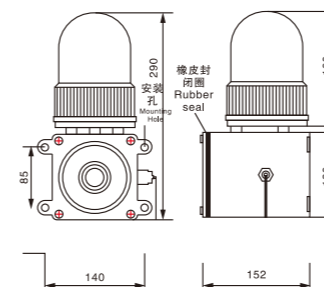

### Functions and features

1. Simple to use, continuous work for a long time.
2. Special integrated chip design, super electromagnetic anti-interference performance.
3. The inner core of the flash lamp is an LED tube, which has a long service life.
4. The shell is made of aluminum alloy die-casting, which has good waterproof, moisture-proof and shock-proof functions.

### Parameters

|                 |   |                  |                            |
|-----------------|---|------------------|----------------------------|
| Model           | STSG-05                                     | Frequency        | 50/60Hz                    |
| Work humidity   | -30℃~+70℃                                   | Protection grade | IP56                       |
| Sound frequency | 800Hz ( Tone D )                            | Material         | Shade: ABS Lamp: PC        |
| Net weight      | 1.2kg                                       | Voltage          | DC12V/24V AC220V/380V      |
| Decibel         | 110dB                                       | Color(Lamp)      | Red Yellow Blue Green      |
| Power           | 10~25W                                      | Dimension        | 140(L) × 152(W) × 290(H)mm |
| Tone            | Siren sound, other tones can be customized. |                  |                            |

Application field: Suitable for safety signal devices of expressways, road junctions, underground tunnels and cranes.

## STSG-10

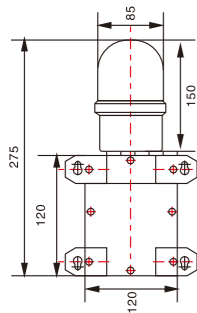

### Functions and features

1. Simple to use, continuous work for a long time.
2. Special integrated chip design, super electromagnetic anti-interference performance.
3. The inner core of the flash lamp is an LED tube, which has a long service life.
4. The shell is made of aluminum alloy die-casting, which has good waterproof, moisture-proof and shock-proof functions.

### Parameters

|                 |   |                  |                            |
|-----------------|---|------------------|----------------------------|
| Model           | STSG-10                                     | Frequency        | 50/60Hz                    |
| Work humidity   | -30℃~+70℃                                   | Protection grade | IP56                       |
| Net weight      | 1.1kg                                       | Voltage          | DC12V/24V AC220V/380V      |
| Decibel         | 110dB                                       | Color(Lamp)      | Red Yellow Blue Green      |
| Sound frequency | 800Hz ( Tone D )                            | Dimension        | 120(L) × 120(W) × 275(H)mm |
| Material        | Shade: Aluminum alloy Lamp: PC              |                  |                            |
| Tone            | Siren sound, other tones can be customized. |                  |                            |

Application field: Suitable for large and medium-sized cranes and ship terminal conveying equipment in port machinery and electromechanical industries.

## STSG-10Y

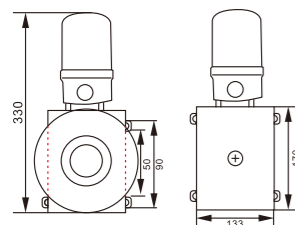

### Functions and features

1. Infrared sensor probe, wide detection range.
2. Remote wireless remote control, the longest distance can reach 1000m.
3. Special integrated chip design, super electromagnetic anti-interference performance.
4. The inner core of the flash lamp is an LED tube, which has a long service life.
5. The shell is made of aluminum alloy die-casting, which has good waterproof, moisture-proof and shock-proof functions.

### Parameters

|               |   |                  |                            |
|---------------|---|------------------|----------------------------|
| Model         | STSG-10Y                                    | Sound frequency  | 800Hz ( Tone D )           |
| Work humidity | -30℃~+70℃                                   | Protection grade | IP56                       |
| Frequency     | 50/60Hz                                     | Voltage          | DC12V/24V AC220V/380V      |
| Net weight    | 3.1kg                                       | Color(Lamp)      | Red Yellow Blue Green      |
| Decibel       | 120dB                                       | Dimension        | 133(L) × 133(W) × 330(H)mm |
| Material      | Shade: Aluminum alloy Lamp: PC Speaker: ABS |                  |                            |
| Tone          | Siren sound, other tones can be customized. |                  |                            |

Application field: Suitable for machinery, bridges, industrial ports, warehouses, cranes and industrial exhaust emissions.

## STSG-22



### Functions and features

1. With volume and type adjustment switch, 7 kinds of sounds can be selected.
2. Special integrated chip design, super electromagnetic anti-interference performance.
3. The inner core of the flash lamp is an LED tube, which is made of the characteristics of a single-chip microcomputer. The number of flashes per second can be determined according to customer requirements.
4. The shell is made of aluminum alloy die-casting, which can effectively resist salt spray corrosion and has good waterproof, moisture-proof and shock-proof functions.
5. Stainless steel mesh cover effectively protects the warning lights and prevents collisions.

### Parameters

|                 |   |                  |                                |
|-----------------|---|------------------|--------------------------------|
| Model           | STSG-22                                     | Frequency        | 50/60Hz                        |
| Work humidity   | -30℃~+70℃                                   | Protection grade | IP56                           |
| Net weight      | 1.1kg                                       | Voltage          | DC12V/24V AC220V/380V          |
| Decibel         | 106~140dB                                   | Color(Lamp)      | Red Yellow Blue Green          |
| Output power    | 6~25W                                       | Dimension        | 120(L) × 120(W) × 275(H)mm     |
| Sound frequency | 800Hz ( Tone D )                            | Material         | Shade: Aluminum alloy Lamp: PC |
| Tone            | Siren sound, other tones can be customized. |                  |                                |

Application field: Suitable for safety signal devices of expressways, road junctions, underground tunnels and cranes.

## STSG-22T

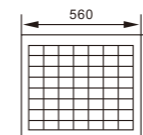
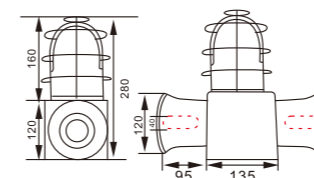

太阳能版尺寸  
Solar panel size

### Functions and features

1. With volume and type adjustment switch, 7 kinds of sounds can be selected.
2. Large area solar panel, large capacity battery, long working time.
3. Light control sensor, switch control.
4. The shell is made of aluminum alloy die-casting, which can effectively resist salt spray corrosion and has good waterproof, moisture-proof and shock-proof functions.
5. Stainless steel mesh cover effectively protects the warning lights and prevents collisions.
6. Dual speakers alarm, wide spreading range.

### Parameters

|                 |   |                  |                                |
|-----------------|---|------------------|--------------------------------|
| Model           | STSG-22T                                  | Frequency        | 50/60Hz                        |
| Work humidity   | -30℃~+70℃                                 | Protection grade | IP56                           |
| Sound frequency | 800Hz ( Tone D )                          | Material         | Shade: Aluminum alloy Lamp: PC |
| Net weight      | 3.5kg                                     | Voltage          | DC12V/24V AC220V/380V          |
| Decibel         | 106~140dB                                 | Color(Lamp)      | Red Yellow Blue Green          |
| Output power    | 6~25W                                     | Dimension        | 315(L) × 120(W) × 280(H)mm     |
| Solar panels    | Polycrystalline silicon solar power panel |                  |                                |
| Tone            | A, other tones can be customized.         |                  |                                |

Application field: Suitable for large and medium-sized cranes and ship terminal conveying equipment in port machinery and electromechanical industries.

## STSG-50

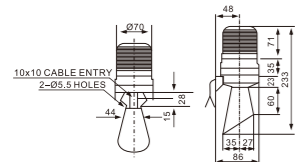

### Functions and features

1. Built-in high volume buzzer, the maximum decibel can reach 100dB.
2. Built-in diffuser light, high visibility, which can be long-bright or flashing.
3. Wall-mounted installation, compact and convenient, can be installed in a small space.

### Parameters

|            |            |                  |                          |
|------------|------------|------------------|--------------------------|
| Model      | STSG-50    | Frequency        | 50/60Hz                  |
| Flash      | 60~80t/min | Protection grade | IP54                     |
| Net weight | 1.5kg      | Voltage          | DC12V/24V AC220V/380V    |
| Decibel    | 100dB      | Color(Lamp)      | Red Yellow Blue Green    |
| Power      | 10W        | Dimension        | 86(L) × 70(W) × 233(H)mm |

Application field: Suitable for safety signal devices of expressways, road junctions, underground tunnels and cranes.

## STSG-200



### Functions and features

1. Double speaker electronic buzzer with loud alarm sound.
2. Made of ABS engineering plastic, light weight and anti-corrosion.
3. Alarm light core is LED tube, warning light flashing times can be customized.

### Parameters

|            |                            |                  |                       |
|------------|----------------------------|------------------|-----------------------|
| Model      | STSG-200                   | Sound frequency  | 800Hz ( Tone D )      |
| Decibel    | 106~120dB                  | Protection grade | IP56                  |
| Net weight | 1.85kg                     | Color(Lamp)      | Red Yellow Blue Green |
| Frequency  | 50/60Hz                    | Voltage          | DC12V/24V AC220V/380V |
| Power      | 10~25W                     | Material         | Shade: ABS Lamp: PC   |
| Dimension  | 250(L) × 210(W) × 320(H)mm |                  |                       |

Application field: Suitable for safety signal devices of expressways, road junctions, underground tunnels and cranes.

## STSG-808

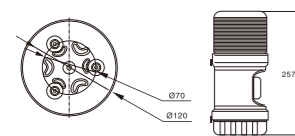

### Functions and features

1. LED flashing light source, high-brightness flashing, 100 times/min.
2. Built-in 5 kinds of voices, 3 kinds of alarm tones can be selected, wide application range.
3. Intelligent sound and light alarm with adjustable volume.
4. The lampshade is made of PC material, good light transmission, UV resistance and aging resistance.

### Parameters

|            |   |                  |                       |
|------------|---|------------------|-----------------------|
| Model      | STSG-808                                    | Power            | 20W                   |
| Decibel    | 90~114dB                                    | Protection grade | IP56                  |
| Net weight | 1.2kg                                       | Color(Lamp)      | Red                   |
| Frequency  | 10/20Hz                                     | Voltage          | DC12V/24V AC220V/380V |
| Material   | Shade: ABS Lamp: PC                         |                  |                       |
| Dimension  | 120(L) × 120(W) × 257(H)mm                  |                  |                       |
| Tone       | Siren sound, other tones can be customized. |                  |                       |

Application field: Suitable for safety signal devices of expressways, road junctions, underground tunnels and cranes.

## STSG-06

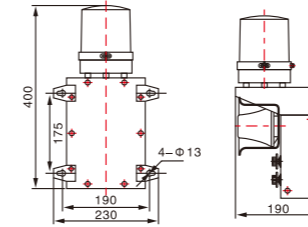

### Functions and features

1. This product has 6 voices and 1 alarm sound.
2. The shell is made of high-quality steel die-casting, effectively resist salt spray corrosion, rainproof and dustproof.
3. With voice and volume adjustment switches, the operation is simple and convenient.

### Parameters

|                  |  |                  |                            |
|------------------|--|------------------|----------------------------|
| Model            | STSG-06  | Frequency        | 50/60Hz                    |
| Current          | 1.5A   | Protection grade | IP56                       |
| Net weight       | 5.1kg  | Voltage          | AC220V/380V                |
| Decibel          | 110dB  | Color(Lamp)      | Red                        |
| Power            | 25W  | Dimension        | 230(L) × 190(W) × 400(H)mm |
| Contact capacity | 24V~380V DC/AC   | Material         | Shade: steel Lamp: PC      |
| Tone             | Alarm sound, air defense sound, engineering sound, voice prompt. |                  |                            |

Application field: Suitable for safety signaling devices of large and medium-sized cranes and ships, terminal conveying equipment in port machinery, electromechanical industries, expressways, underground tunnels and cranes.

## STSG-07

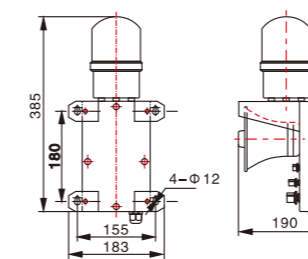

### Functions and features

1. This product has 6 voices and 1 alarm sound.
2. The shell is made of high-quality steel die-casting, effectively resist salt spray corrosion, rainproof and dustproof.
3. With voice and volume adjustment switches, the operation is simple and convenient.

### Parameters

|                  |  |                  |                            |
|------------------|--|------------------|----------------------------|
| Model            | STSG-07  | Frequency        | 50/60Hz                    |
| Current          | 3A   | Protection grade | IP56                       |
| Net weight       | 5.1kg  | Voltage          | AC220V/380V DC24V/48V      |
| Decibel          | 120dB  | Color(Lamp)      | Red                        |
| Contact capacity | 24V~380V DC/AC 1.5A  | Dimension        | 183(L) × 190(W) × 385(H)mm |
| Power            | 20w、30w、60w、80w、100w   | Material         | Shade: steel Lamp: PC      |
| Tone             | Alarm sound, air defense sound, engineering sound, voice prompt. |                  |                            |

Application field: Suitable for safety signaling devices of large and medium-sized cranes and ships, terminal conveying equipment in port machinery, electromechanical industries, expressways, underground tunnels and cranes.

**STSG-YH-07**

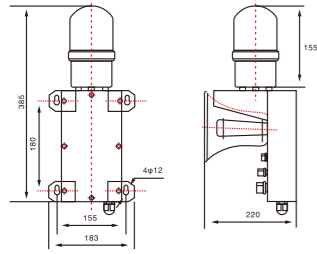

**Functions and features**

1. This product is an upgraded version of 07, with large speakers and louder sound.
2. This product has 6 voices and 1 alarm sound.
3. The shell is made of high-quality steel die-casting, effectively resist salt spray corrosion, rainproof and dustproof.
4. With voice and volume adjustment switches, the operation is simple and convenient.

**Parameters**

|                  |  |                  |                            |
|------------------|--|------------------|----------------------------|
| Model            | STSG-YH5-07  | Frequency        | 50/60Hz                    |
| Current          | 3A   | Protection grade | IP56                       |
| Net weight       | 5.1kg  | Voltage          | AC220V/380V DC24V/48V      |
| Decibel          | 130dB  | Color(Lamp)      | Red                        |
| Contact capacity | 24V~380V DC/AC 1.5A  | Dimension        | 183(L) × 220(W) × 385(H)mm |
| Power            | 20w、30w、60w、80w、100w   | Material         | Shade: steel Lamp: PC      |
| Tone             | Alarm soun, air defense sound engineering sound, voice prompt. |                  |                            |

Application field: Suitable for safety signaling devices of large and medium-sized cranes and ships, terminal conveying equipment in port machinery, electro mechanical industries, expressways, nderground tunnels and cranes.

**STSG-KGL-156**

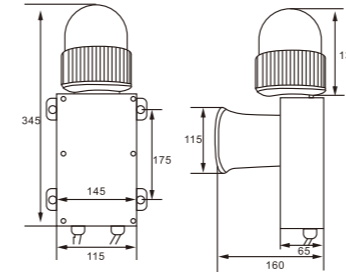

**Product description**

STSG-KGL-156 switch signal alarm is a new product developed by our company according to the actual requirements of customers. This product detects abnormal conditions through external equipment, outputs a switch alarm signal, automatically triggers the alarm, and the alarm uses sound and light to alarm, which is timely and effective.

**Features**

1. The product can be connected to 9 external devices at the same time, if other quantities are required, it can be customized.
2. The product has 9 voices, and each external device is connected to one voice.

**Parameters**

|             |  |                  |                            |
|-------------|--|------------------|----------------------------|
| Model       | STSG-KGL-156   | Frequency        | 50/60Hz                    |
| Color(Lamp) | Red  | Protection grade | IP56                       |
| Net weight  | 5.8kg  | Voltage          | AC110V/220V/380V DC12V/24V |
| Decibel     | 120dB  | Dimension        | 150(L) × 160(W) × 345(H)mm |
| Material    | Shade: steel Lamp: PC  |                  |                            |
| Tone        | Alarm sound, air defense sound, engineering sound, voice prompt. |                  |                            |

Application field: Suitable for safety signaling devices of large and medium-sized cranes and ships, terminal conveying equipment in port machinery, electromechanical industries, expressways, underground tunnels and cranes.

**STSG-08**

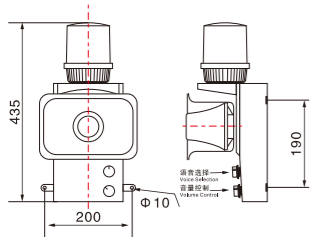

**Functions and features**

1. This product has 6 voices and 1 alarm sound.
2. The shell is made of high-quality steel die-casting, effectively resist salt spray corrosion, rainproof and dustproof.
3. With voice and volume adjustment switches, the operation is simple and convenient.
4. Warning lights include rotating incandescent lights and LED strobe lights.

**Parameters**

|             |  |                  |                            |
|-------------|--|------------------|----------------------------|
| Model       | STSG-08  | Frequency        | 50/60Hz                    |
| Color(Lamp) | Red  | Protection grade | IP56                       |
| Net weight  | 5.3kg  | Voltage          | AC220V/380V DC24V/36V      |
| Decibel     | 120dB  | Dimension        | 200(L) × 195(W) × 435(H)mm |
| Sound power | 50-200W  | Material         | Shade: steel Lamp: PC      |
| Light power | Incandescent lights: 10w LED: 2.5w                             |                  |                            |
| Tone        | Alarm soun, air defense sound engineering sound, voice prompt. |                  |                            |

Applicationfield: suitable for safety signaling devices of large and medium-sized cranes and ships, terminal conveying equipment in port machinery electro mechanical industries, expressways, underground tunnels and cranes.

**SJ-02**

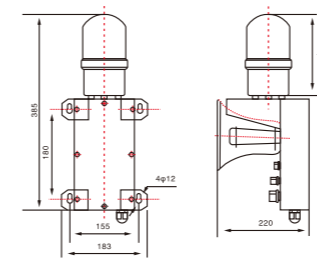

**Functions and features**

1. This product has 6 voices and 1 alarm sound.
2. The shell is made of aluminum alloy die-casting, effectively resist salt spray corrosion, rainproof and dustproof.

**Parameters**

|                  |                     |           |  |       |
|------------------|---------------------|-----------|--|-------|
| Model            | SJ-2                | SJ-2L     | SJ-3W                                    | SJ-3L |
| Light            | Incandescent lamp   | LED       | Incandescent lamp                        | LED   |
| Decibel          | 110dB               | 120dB     |  |       |
| Color(Lamp)      | Red,yellow,blue     | Voltage   | DC12V / 24V , AC36V / 110V / 220V / 380V |       |
| Contact capacity | 24V~380V DC/AC 1.5A | Material  | Aluminum alloy                           |       |
| Protection grade | IP56                | Dimension | 250(L) × 220(W) × 480(H)mm               |       |
| Net weight       | 5.5kg               |           |  |       |

Application: Suitable for safety signaling devices of large and medium-sized cranes and ships, terminal conveying equipment in port machinery, electro mechanical industries, expressways, underground tunnels and cranes.



## SHD2L



### Functions and features

1. This product has 6 voices and 1 alarm sound.
2. The shell is made of aluminum alloy die-casting, effectively resist salt spray corrosion, rainproof and dustproof.
3. Double speaker design, the sound is louder.
4. With voice and volume adjustment switches, the operation is simple and convenient.

### Parameters

|   |  |                  |                                |
|---|--|------------------|--------------------------------|
| Model   | SHD2L  | Frequency        | 50/60Hz                        |
| Net weight  | 3.5kg  | Protection grade | IP56                           |
| Decibel   | 106~120dB  | Voltage          | AC220V/380V DC24V/36V          |
| Color(Lamp)   | Red,yellow   | Dimension        | 31.5(L) × 12(W) × 28(H)cm      |
| Contact capacity  | 24V~380V DC/AC<br>1.5A   | Material         | Shade: aluminum alloy Lamp: PC |
| Tone  | Alarm sound, air defense sound, engineering sound, voice prompt. |                  |                                |
| Application field: Suitable for safety signaling devices of large and medium-sized cranes and ships, terminal conveying equipment in port machinery, electromechanical industries, expressways, underground tunnels and cranes. |  |                  |                                |

## DWJ-10

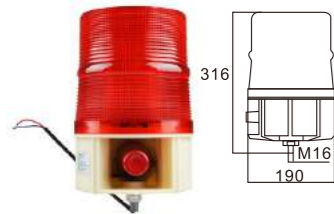

### Features

1. With a small speaker, the sound is loud and clear.
2. High-quality transparent lampshade, using high-quality PC material, waterproof and dustproof.
3. Install the base with bolts, install and fix to prevent vibration.

### Parameters

|             |                     |           |  |
|-------------|---------------------|-----------|--|
| Model       | DWJ-10              | Decibel   | 110dB                                    |
| Color(Lamp) | Red ,yellow         | Dimension | 190(L) × 190(W) × 316(H)m                |
| Net weight  | 0.95kg              | Voltage   | DC12V / 24V , AC36V / 110V / 220V / 380V |
| Material    | Base: ABS Shade: PC |           |  |

## BC-809



### Features

1. High-brightness flashing, loud alarm sound and optional tone.
2. The lampshade is made of PC material, which has good light transmission, UV and aging resistance.
3. The warning light has two pulse flashing modes: xenon lamp and LED tube.
4. Three installation methods: screw fixation, strong magnetic adsorption, flange installation.

### Parameters

|                  |  |             |                          |
|------------------|--|-------------|--------------------------|
| Model            | BC-809   | Frequency   | 50/60Hz                  |
| Protection grade | IP56   | Color(Lamp) | Red ,yellow,Green        |
| Net weight       | 0.4kg  | Power       | 10W                      |
| Decibel          | 108~110dB  | Dimension   | 85(L) × 85(W) × 158(H)mm |
| Material         | Base: nylon+GF30% Shade: PC  |             |                          |
| Voltage          | DC12V / 24V , AC36V / 110V / 220V / 380V   |             |                          |
| Selection Guide  | BC-809: 3 M6 screws for installation<br>BC-809C: Magnetic steel fixed installation<br>BC-809F: Flange installation<br>PJ061: Special lampshade |             |                          |

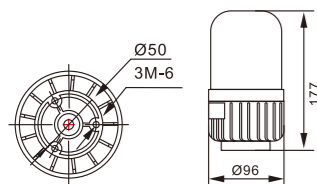

## FI4870



### Functions & Features

1. Using a new red LED light source, strong brightness, visible distance above 4800 meters, thick smoke and fog penetration of 300 to 500 meters.
2. Using programmable IC to control the circuit board, switch between Sound & Light and Sound modes.
3. Adopt high-energy non-memory battery, with good charging and discharging performance, high capacity, can work continuously for 15 hours after a one-time full charge.
4. The bottom is a strong magnetic base, which can be directly attached to the iron plate, which is convenient to use.
5. Imported PC material enhances the impact of the alarm and prolongs its service life.

### Use

1. When in use, the first time press the switch button of the lamp, it is Sound & Light mode; the second time is Sound mode; the third time it stops working.
2. After a full charge, it can be used at any time within 3 months; if it is stored for a long time, it needs to be charged every 4-5 months. In use, when the power is exhausted, the brightness of the warning light will be sharply reduced or stop working, so stop using it and charge it in time.
3. The charger has a built-in charging protection device. When the charger is powered on but not charging, the indicator light is green. When the alarm is connected for charging, the indicator light is red. When fully charged, the indicator light is green.

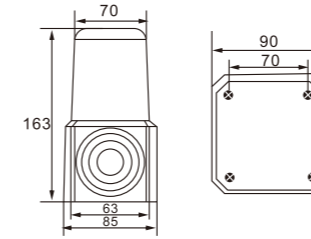

### Application

Suitable for warning signs in various special places, signal contact and direction indication for municipal, construction work and guardianship, ambulance and emergency personnel.

### Parameters

|                           |  |              |                     |
|---------------------------|--|--------------|---------------------|
| Product name              | FL4870 multifunctional rechargeable audible visual alarm |              |                     |
| Rated voltage             | DC3.7V   | Battery life | 1000times(Cycle)    |
| Net weight                | 0.6kg  | Decibel      | 115dB               |
| Rated capacity            | 4Ah  | Material     | Base: ABS Shade: PC |
| Dimension                 | 96(L) × 96(W) × 165(H)mm                                 |              |                     |
| Continuous discharge time | Sound ≥ 6h/Sound&Light ≥ 5h                              |              |                     |
| LED                       | Current  | 250mA        |                     |
|                           | Average use time   | 100000h      |                     |
| Charging time             | Normal   | 6h           |                     |
|                           | Dead battery   | 8h           |                     |

## STJD90B



### Features

1. Round base, reserved for waterproof slot, can be embedded with waterproof apron.
2. Screw fixed installation, with stand and without stand base.
3. PC transparent lamp shade, good light transmission, strong brightness, and good warning effect.

### Parameters

|            |         |                  |                              |
|------------|---------|------------------|------------------------------|
| Model      | STJD90B | Frequency        | 50/60Hz                      |
| Net weight | 0.4kg   | Protection grade | IP56                         |
| Decibel    | 120dB   | Voltage          | DC12V / 24V , AC220V / 380V  |
| Color      | Red     | Dimension        | 85(L) × 85(W) × 140/200(H)mm |
| Current    | 0.18A   | Material         | Base: ABS Shade: PC          |

Application: Suitable for road construction, railway isolation, traffic construction warning etc.

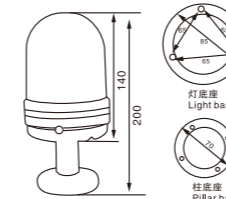

**PLUM BLOSSOM WARNING LIGHT**

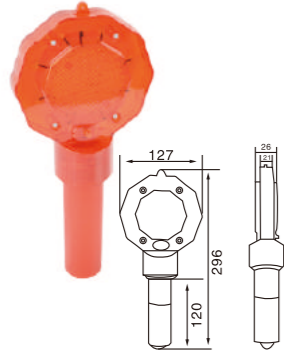

**Features**

1. PC plastic shell, good light transmission and dust resistance.
2. Deep red switch button, simple and convenient.

**Parameters**

|   |                             |            |                           |
|---|-----------------------------|------------|---------------------------|
| Model   | Handle strobe warning light |            |                           |
| Power   | 0.02W                       | Battery    | 2 AA battery Material     |
| Decibel   | 120dB                       | Voltage    | 3V                        |
| Decibel   | 60t/min                     | Material   | Plastic                   |
| Color   | Red                         | Dimension  | 127(L) × 28(W) × 295(H)mm |
| Light   | 10 LED                      | Net weight | 0.35kg                    |
| Application: Suitable for road construction, railway isolation, traffic construction warning etc. |                             |            |                           |

**ST-ABC-9**

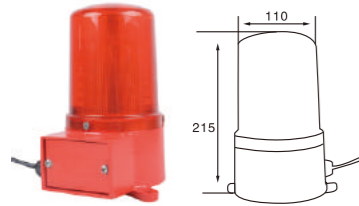

**Features**

1. The base is made of aluminum alloy, which is anti-corrosion and moisture-proof.
2. PC transparent lampshade, good light transmission, and good warning effect.
3. LED high-brightness light source, flashing frequency 35t/min, strong brightness.

**Parameters**

|  |               |             |                            |
|--|---------------|-------------|----------------------------|
| Model  | ST-ABC-9      | Frequency   | 50/60Hz                    |
| Protection grade   | IP56          | Color(Lamp) | Red                        |
| Net weight   | 2.3kg         | Power       | 8W                         |
| Decibel  | 120dB         | Dimension   | 113(L) × 125(W) × 215(H)mm |
| Voltage  | DC24V, AC220V | Material    | Base: ABS Shade: PC        |
| Application: Suitable for lifting equipment such as construction machinery (traveling cranes, crawler cranes, tire cranes, etc.), port machinery (gate cranes, bridge cranes, etc.). |               |             |                            |

**SOLAR ALARM**

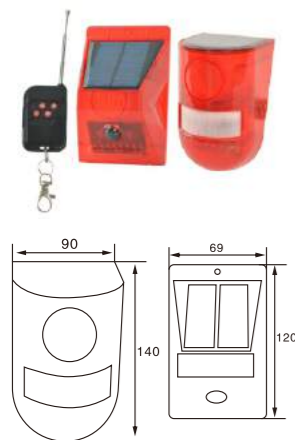

**Features**

1. High efficiency solar panel, fast charging efficiency.
2. PIR human body induction, automatic light alarm.
3. High-decibel LED light, the light flashes quickly, and the position is clearly distinguished.
4. 4 working modes for selection.

**Parameters**

|                    |   |                  |   |
|--------------------|---|------------------|---|
| Model              | N911/N911C  | LED              | 6 flashing red lights, visible at 1km           |
| Charging method    | solar charging  | Solar panel      | 5V*80mA polysilicon                             |
| Charging time      | 6-8h  | Material         | ABS   |
| Alarm sound        | 129dB   | Waterproof level | IP65  |
| G.w.               | N911: 0.25kg<br>N911C: 0.3kg  | Dimensions       | N911: 85 × 75 × 120mm<br>N911C: 90 × 75 × 145mm |
| Sensing distance   | 5-8 meters (affected by ambient temperature)  |                  |   |
| Sensing angle      | mode direction sensing angle 125°   |                  |   |
| Battery parameters | 3.7V*400mAH group capacity polymer lithium battery  |                  |   |
| Working time       | induction, audible and visual alarm > 300 times, standby work > 50 days after charging  |                  |   |
| Product function   | Level 1: 24-hour sound and light alarm mode<br>Level 2: 24-hour flashing silent alarm mode<br>Level 3: Sound and light alarm mode at night<br>Level 4: Flash silent alarm mode at night |                  |   |

**STSG-702**

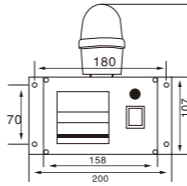

**Features**

1. The upper and lower limit high temperature and low temperature alarm, the temperature can be set.
2. Equipped with screw probe, simple operation and precise measurement.

**Parameters**

|   |                   |                   |                             |
|---|-------------------|-------------------|-----------------------------|
| Product name  | Temperature alarm |                   |                             |
| Net weight  | 1.5kg             | 螺钉探头              | M8*1.2mm*18mm               |
| Decibel   | 90/105dB          | Voltage           | AC220V                      |
| Installation  | Screw fixation    | Dimension         | 20(L) × 10.7(W) × 21.3(H)cm |
| Alarm   | Sound and light   | Temperature range | 0-1200℃                     |
| Material  | ABS               |                   |                             |
| Application: Suitable for electronic equipment, machine tool equipment, medical equipment, restaurants, warehouses etc. |                   |                   |                             |

**LTE-RH203**

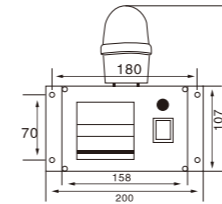

**Features**

1. With integrated temperature and humidity sensor, the sensor cable length is 1.5m.
2. Aluminum alloy shell, anti-aging and anti-corrosion.
3. Digital display, temperature and humidity can be set.
4. When the temperature/humidity exceeds the alarm, press the mute button to cancel the sound. When the temperature and humidity return to normal, the button will automatically reset.

**Parameters**

|   |                                |                   |                             |
|---|--------------------------------|-------------------|-----------------------------|
| Product name  | Temperature and humidity alarm |                   |                             |
| Voltage   | AC220V                         | Decibel           | 105dB                       |
| Material  | ABS                            | Temperature range | 0-1200℃                     |
| Installation  | Screw fixation                 | Alarm             | Sound and light             |
| Net weight  | 1.5kg                          | Dimensions        | 20(L) × 10.7(W) × 21.3(H)cm |
| Application: Suitable for electronic equipment, machine tool equipment, medical equipment, restaurants, warehouses etc. |                                |                   |                             |

**TIMING ALARM**

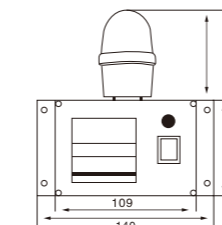

**Product description**

- 1.3 timing modes, time can be set freely.  
S: 0.01s ~ 99.99S; M: 1s ~ 99min99S; H: 1min ~ 99h99min
2. It can alarm for single-off and circular timing. Single-off alarm: start the alarm at the set time, press the button to end the alarm. Circular alarm: alarm once at the set time, re-time, continue to alarm, and recycle.
3. The button is used to start and pause, and can be changed to a self-resetting type.
4. With memory function, the time only needs to be adjusted once.

**Parameters**

|   |                   |            |                             |
|---|-------------------|------------|-----------------------------|
| Product name  | Timing alarm      | Power      | 3W                          |
| Contact capacity  | AC220V 3A         | Material   | ABS                         |
| Decibel   | 105dB             | Voltage    | AC220V                      |
| Frequency   | 50/60Hz           | Dimension  | 14(L) × 10.9(W) × 20.9(H)cm |
| Mechanical life   | ≥ 1 million times | Net weight | 0.65kg                      |
| Application: Suitable for electronic equipment, machine tool equipment, medical equipment, restaurants, warehouses etc. |                   |            |                             |

**GST-HZ-M8503**



**Product description**

GST-HZ-M8503 fire alarm is a kind of sound and light alarm equipment installed on the scene. The alarm receives the signal and sends out a strong sound and light alarm signal, which has reached the purpose of reminding people on the spot. 3 kinds of alarm sounds are adjustable.

**Alarm principle**

Adopt the principle of resonance. A buzzer film is installed on the vocal cavity, which causes the buzzer film to vibrate after power-on, causing the vocal cavity to resonate.

**Speak**

Composed of buzzer, pronunciation cavity, and pronunciation cavity cover.

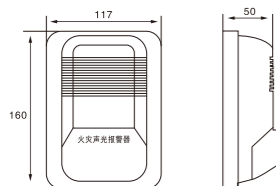

**Parameters**

|                      |                         |                     |                          |
|----------------------|-------------------------|---------------------|--------------------------|
| Product name         | GST-HZ-M8503 fire alarm |                     |                          |
| Voltage              | DC24V                   | Current             | 30mA                     |
| Flash frequency      | 1.1Hz~1.7Hz             | Material            | ABS                      |
| Decibel              | 80~110dB(3m)            | Pitch change        | 2s~4.5s                  |
| G.w.                 | 0.6kg                   | Dimension           | 11.7(L) × 5(W) × 16(H)cm |
| Hole distance        | 66.7mm                  | Ambient temperature | -10℃~+50℃                |
| Environment humidity | ≤95%RH 40℃              |                     |                          |



**Product description**

The alarm shell is made of aluminum alloy shell, the lamp shell has strong impact resistance, 180° clearly visible ultra-bright LED light-emitting tube, equipped with a super buzzer, stable work, long service life, low power consumption, not affected by pollutants and water.

**Applicable place**

Explosion-proof audible and visual alarms are mainly used in dangerous places with explosive gas mixtures: Zone 1, Zone 2 Class IIA, IIB, IIC, and the temperature group is T1~T6 inflammable and explosive places. It is suitable for hazardous locations such as chemical plants, gas stations, petroleum extraction and refining, mines, laboratories, and docks. The alarm can emit sound and light signals at the same time.

**Product Standards**

GB3836.1—2000 Electrical Equipment for Explosive Gas Atmosphere Part 1: General Requirements";  
 GB3836.2-2000 Electrical Equipment for Explosive Gas Atmosphere Part 2: Flameproof 'd';  
 GB3836.4-2000 Electrical Equipment for Explosive Gas Atmosphere Part 4: Intrinsically Safe 'i'".

**Features**

1. Aluminum alloy shell, high-voltage electrostatic spray on the surface.
2. Good insulation performance, sturdy shell and anti-aging.
3. Super thick tempered glass, high impact resistance.

**BBJ**

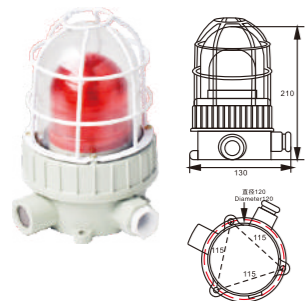

**Parameters**

|                  |  |                      |                           |
|------------------|--|----------------------|---------------------------|
| Product name     | BBJ explosion-proof audible and visual alarm |                      |                           |
| Net weight       | 1.35kg                                       | Power                | 10W                       |
| Decibel          | 110dB  | Voltage              | AC220V,DC24V              |
| Flash frequency  | 150t/min                                     | Dimension            | 13(L) × 13(W) × 21.5(H)cm |
| Inlet thread     | G3/4(G" )                                    | Explosion-proof mark | Exd II BT4                |
| Protection class | IP65   | Cable outer diameter | φ 8-14mm                  |
| Material         | Base: Aluminum Alloy Shade: Tempered Glass   |                      |                           |
| Color            | Lamp: Red, Yellow, Blue Base: Gray           |                      |                           |

**BBJ-02**



**Parameters**

|                  |   |                      |                            |
|------------------|---|----------------------|----------------------------|
| Product name     | BBJ-02 explosion-proof audible and visual alarm |                      |                            |
| Net weight       | 2kg   | Power                | 10W                        |
| Decibel          | 125dB   | Voltage              | AC36V/220V,DC24V           |
| Flash frequency  | 150t/min  | Dimension            | 120(L) × 120(W) × 201(H)cm |
| Inlet thread     | G3/4(G" )                                       | Explosion-proof mark | Exd II BT4                 |
| Protection class | IP65  | Cable outer diameter | φ 8-14mm                   |
| Material         | Base: Aluminum Alloy Shade: Tempered Glass      |                      |                            |
| Color(Lamp)      | Lamp: Red, Yellow, Blue Base: Yellow            |                      |                            |

**BDJ-01**



**Parameters**

|                  |   |                      |                             |
|------------------|---|----------------------|-----------------------------|
| Product name     | BDJ-01 explosion-proof audible and visual alarm |                      |                             |
| Net weight       | 1.8kg   | Power                | 10W                         |
| Decibel          | 95-110dB  | Voltage              | AC220V,DC24V                |
| Flash frequency  | 150t/min  | Dimension            | 14.5(L) × 14.5(W) × 21(H)cm |
| Inlet thread     | G3/4(G" )                                       | Explosion-proof mark | Exd II BT4                  |
| Protection class | IP65  | Cable outer diameter | φ 8-14mm                    |
| Material         | Base: Aluminum Alloy Shade: Tempered Glass      |                      |                             |
| Color(Lamp)      | Lamp: Red, Yellow, Blue Base: Yellow            |                      |                             |

**BDJ-02**



**Parameters**

|                  |   |                      |                             |
|------------------|---|----------------------|-----------------------------|
| Product name     | BDJ-02 explosion-proof audible and visual alarm |                      |                             |
| Net weight       | 3kg   | Power                | 40W                         |
| Decibel          | 125dB   | Voltage              | AC220V,DC24V/36V            |
| Flash frequency  | 150t/min  | Dimension            | 27.5(L) × 14(W) × 23.5(H)cm |
| Inlet thread     | G3/4(G" )                                       | Explosion-proof mark | Exd II BT4                  |
| Protection class | IP65  | Cable outer diameter | φ 8-14mm                    |
| Material         | Base: Aluminum Alloy Shade: Tempered Glass      |                      |                             |
| Color(Lamp)      | Lamp: Red, Yellow, Blue Base: Yellow Horn: Red  |                      |                             |

**FXS-SG-1**



**Parameters**

|                  |   |                      |                           |
|------------------|---|----------------------|---------------------------|
| Product name     | FXS-SG-1 explosion-proof audible and visual alarm |                      |                           |
| Net weight       | 1.5kg   | Power                | 40W                       |
| Decibel          | 90dB  | Voltage              | AC220V,DC12V/24V          |
| Flash frequency  | 60t/min   | Dimension            | 15(L) × 14(W) × 13.5(H)cm |
| Current          | 120mA   | Ambient temperature  | -20℃~+50℃                 |
| Protection class | IP65  | Humidity             | ≤95%RH                    |
| Air pressure     | 80kPa~110kPa                                      | Explosion-proof mark | Exd II CT6                |
| Color            | Lamp: Red, Base: Red                              |                      |                           |
| Material         | Base: Aluminum Alloy Shade: Tempered Glass        |                      |                           |

**STJD-10-24V**



**Product description**

STJD-10-24V type explosion-proof audible and visual alarm is designed with special integrated circuit, which is stable in operation and long in service life. It uses super bright light-emitting tube inside, which has the characteristics of small size, loud sound, light weight and low price. It is suitable for node type combustible gas series and point type toxic series gas detectors and other detectors and alarms with node output. Explosion-proof mark: Exd II CT6 Gb

**Parameters**

|              |   |                   |              |
|--------------|---|-------------------|--------------|
| Product name | Explosion-proof audible and visual alarm<br>G3/4 interface, M20*1.5 interface, G1/2 interface |                   |              |
| Voltage      | 24V   | Decibel           | 100db@10cm   |
| Material     | Stainless steel   | Temperature range | 0-1200℃      |
| Current      | 30-50mA   | Light intensity   | 1800-2400mcd |
| Net weight   | 0.4kg   | Dimensions        | φ38 × 98mm   |
| Frequency    | 1s/tNet weight  | Temperature       | -45℃~ +85℃   |
| Humidity     | 10-95%RH  | Air pressure      | 86-105kpa    |
| Live         | Continuous alarm < 5 hours, service life>3 years  |                   |              |

**COMBUSTIBLE  
GES ALARM**



**Product description**

The combustible gas alarm is composed of a detector and an alarm control host. It is widely used in petroleum, gas, chemical, oil depots and other petrochemical industries where there are toxic gases. It is used to detect leakage in indoor and outdoor dangerous places and is an important instrument to ensure production and personal safety. When there is a toxic gas in the place under test, the detector converts the gas signal into a voltage signal or current signal and transmits it to the alarm instrument, and the instrument displays the percentage concentration value of the lower limit of the toxic gas explosion. When the concentration of toxic gas exceeds the alarm setting value, an audible and visual alarm signal will occur, and the personnel take safety measures in time to avoid explosion accidents.

**Installation**

The density of the measured gas is different, and the installation position of the indoor probe should also be different. When the measured gas density is less than the air density, the probe should be installed 30cm away from the roof with a downward direction; otherwise, the probe should be installed 30cm away from the ground with an upward direction.

**COMBUSTIBLE  
GES ALARM****Parameters**

|                       |  |                     |                  |
|-----------------------|--|---------------------|------------------|
| Product name          | Combustible gas alarm Temperature alarm  |                     |                  |
| Net weight            | 1.5kg  | Voltage             | DC24V            |
| Decibel               | 90/105dB   | Voltage             | AC220V           |
| Current               | < 200mA  | Detection method    | Spread naturally |
| Signal output         | 4~20mA   | Humidity            | ≤93%RH           |
| Max. tolerance        | ± 5%(FS)   | Ambient temperature | -40℃ ~ +70℃      |
| Sensor properties     | Catalytic combustion method  |                     |                  |
| Response time         | 90% response time does not exceed 3s   |                     |                  |
| Recovery Time         | ≤ 90s (offset after no gas)  |                     |                  |
| Way of working        | Fixed continuous work  |                     |                  |
| Sensor life           | > 2 years (the poor working environment will shorten sensor life)                                  |                     |                  |
| Explosion-proof grade | Exd II CT6 (Tamb= -40℃~ 75℃)   |                     |                  |
| Connection method     | It can be directly connected with the threaded explosion-proof hose necklace or by simple methods. |                     |                  |



# MOTOR SIREN

**Product Introduction**

The motor alarm is made of special aluminum alloy material, processed by heat treatment, and has strong moisture and corrosion resistance. No jamming, no crash, no deformation, anti-wind and sand, anti-bird nesting. Quick start, stable operation, strong sound penetration and large coverage.

**Application**

Used for civil defense alarm systems; natural disaster alarms; alarm systems for mines, blasting, prisons, reservoirs, power stations, substations, airports, police stations and military bases; emergency alert system of factories, schools, docks, warehouses, public buildings, commercial district and residential area.



**MS-190**

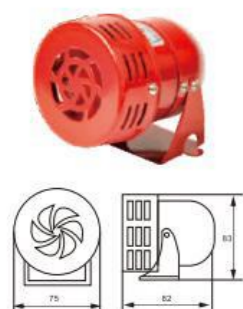

**Parameters**

|                  |                          |                      |                         |
|------------------|--------------------------|----------------------|-------------------------|
| Voltage(V)       | DC12V,24V<br>AC110V,220V | Current(A)           | 6A,2.5A,0.9A,0.43A      |
| Power(W)         | 40W                      | Power(W)             | 50/60Hz                 |
| Decibel          | 110dB(A)(φ 1m)           | Insulation impedance | 100MΩ (at 500VDC)       |
| Sound form       | Continuous sound         | Dielectric strength  | 500VAC,50/60Hz in 1min  |
| Material         | Iron                     | Color                | Red                     |
| Protection grade | IP44                     | Product size         | 75(L) × 82(W) × 83(H)mm |
| Net weight       | 0.45kg                   |                      |                         |

**MS-290**



**Parameters**

|                  |                          |                      |                            |
|------------------|--------------------------|----------------------|----------------------------|
| Voltage(V)       | DC12V,24V<br>AC110V,220V | Current(A)           | 5.8A,2.1A 1.6A,0.8A        |
| Power(W)         | 40W                      | Power(W)             | 50/60Hz                    |
| Decibel          | 112dB(A)(φ 1m)           | Insulation impedance | 100MΩ (at 500VDC)          |
| Sound form       | Continuous sound         | Dielectric strength  | 500VAC,50/60Hz in 1min     |
| Material         | Iron, Plastic            | Color                | Gray                       |
| Protection grade | IP44                     | Product size         | 175(L) × 128(W) × 130(H)mm |
| Net weight       | 0.55kg                   |                      |                            |

**MS-390**

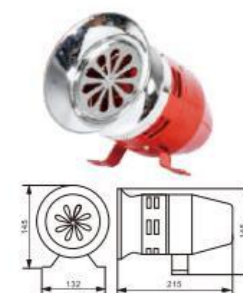

**Parameters**

|                  |                          |                      |                            |
|------------------|--------------------------|----------------------|----------------------------|
| Voltage(V)       | DC12V,24V<br>AC110V,220V | Current(A)           | 12.4A,6.8A 1.5A,1A         |
| Power(W)         | 40W                      | Power(W)             | 50/60Hz                    |
| Decibel          | 116dB(A)(φ 1m)           | Insulation impedance | 100MΩ (500VDC)             |
| Sound form       | Continuous sound         | Dielectric strength  | 500VAC,50/60Hz in 1min     |
| Material         | Aluminum alloy           | Color                | Red                        |
| Protection grade | IP44                     | Product size         | 191(L) × 132(W) × 145(H)mm |
| Net weight       | 1kg                      |                      |                            |

**MS-490**

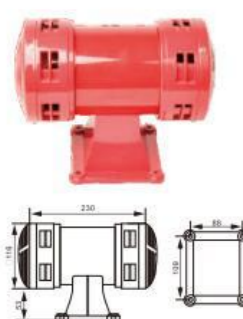

**Parameters**

|                  |                  |                      |                            |
|------------------|------------------|----------------------|----------------------------|
| Voltage(V)       | AC110V,220V      | Current(A)           | 3.4A,1.6A                  |
| Power(W)         | 50/60Hz          | Decibel              | 120B(A)(φ 1m)              |
| Sound form       | Continuous sound | Insulation impedance | 100MΩ (500VDC)             |
| Material         | Aluminum alloy   | Dielectric strength  | 500VAC,50/60Hz in 1min     |
| Protection grade | IP44             | Color                | Red                        |
| Net weight       | 2.75kg           | Product size         | 203(L) × 115(W) × 165(H)mm |

**MS-590**

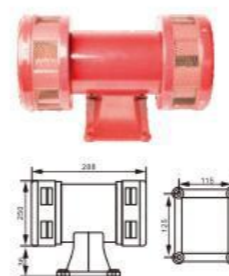

**Parameters**

|                       |                  |                      |                            |
|-----------------------|------------------|----------------------|----------------------------|
| Voltage(V)            | AC110V,220V      | Current(A)           | 3.6A,1.8A                  |
| Power(W)              | 50/60Hz          | Decibel              | 123B(A)(φ 1m)              |
| Sound form            | Continuous sound | Insulation impedance | 100MΩ (500VDC)             |
| Material              | Aluminum alloy   | Dielectric strength  | 500VAC,50/60Hz in 1min     |
| Protection grade      | IP44             | Color                | Red                        |
| Net weight            | 4.85kg           | Product size         | 267(L) × 153(W) × 183(H)mm |
| Transmission distance | 300m             |                      |                            |

**MS-790**

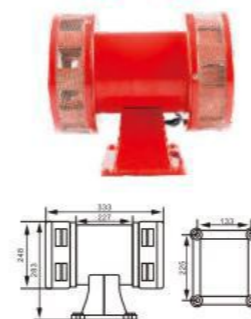

**Parameters**

|                       |                  |                      |                            |
|-----------------------|------------------|----------------------|----------------------------|
| Voltage(V)            | AC110V,220V      | Current(A)           | 4.1A,2.2A                  |
| Power(W)              | 50/60Hz          | Decibel              | 130B(A)(φ 1m)              |
| Sound form            | Continuous sound | Insulation impedance | 100MΩ (500VDC)             |
| Material              | Aluminum alloy   | Dielectric strength  | 500VAC,50/60Hz in 1min     |
| Protection grade      | IP44             | Color                | Red                        |
| Net weight            | 13kg             | Product size         | 333(L) × 248(W) × 283(H)mm |
| Transmission distance | 500m             |                      |                            |

**HCJ-7522**

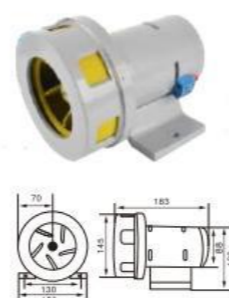

**Parameters**

|              |                      |              |                           |
|--------------|----------------------|--------------|---------------------------|
| Product name | Motor electric siren |              |                           |
| Voltage      | AC220V               | Material     | Aluminum alloy            |
| Current      | 2.08A                | Dimension    | 15(L) × 18.3(W) × 17(H)cm |
| Rated power  | 250W                 | Package size | 18(L) × 21(W) × 20(H)cm   |
| Decibel      | 118dB                | Net weight   | 15kg                      |
| Rated torque | 6500N.M              |              |                           |

## ELECTRIC SIRENS

### Features

1. Special aluminum alloy material, heat treatment processing, strong moisture and corrosion resistance;
2. No jam, no crash, no deformation, anti-wind and sand, anti-bird nesting;
3. Quick start, stable operation, loud sound source, strong penetrating power;
4. The vertical series comes with a rain cap;
5. The protection grade is IP55, and the explosion-proof grade is Exd II BT4.



### Application

1. Used in war and civil defense alarm systems ;
2. Used in mines, blasting, prisons, reservoirs, power stations, substations, airports, police stations, military bases etc.
3. Used for earthquakes, tsunamis, floods, mudslides, landslides, typhoons, fires, minefields, and forest fire prevention;
4. Used in factories, schools, docks, warehouses, public buildings, commercial areas, residential areas, ports etc.

LK-JDL400



### Parameters

|                       |   |              |                                |
|-----------------------|---|--------------|--------------------------------|
| Product name          | LK-JDL400 / LK-JDL480 / LK-JDL550<br>Vertical Siren |              |                                |
| Voltage               | 3-phase 380V  | Material     | Aluminum alloy                 |
| Rated speed           | 2900r/min   | Dimension    | 65(L) × 65(W) × 53(H)cm        |
| Rated power           | 2.2kW / 4kW / 7.5kW                                 | Package size | 75(L) × 75(W) × 63(H)cm        |
| Sound frequency       | 500 ± 20Hz  | Decibel      | 123.3dB / 125.8dB / 128dB @ 5m |
| Start time            | ≤3s   | Net weight   | 51kg / 88kg / 100kg            |
| Transmission distance | 3Km   |              |                                |

JDW-450



### Parameters

|                       |   |              |                         |
|-----------------------|---|--------------|-------------------------|
| Product name          | JDW-450   | JDW-450-2    |                         |
| Voltage               | 3-phase 380V  | Material     | Aluminum alloy          |
| Rated speed           | 2900r/min   | Package size | 75(L) × 63(W) × 71(H)cm |
| Rated power           | 7.5kW   | Decibel      | 130dB @ 5m              |
| Net weight            | 146kg / 147kg   | Start time   | ≤3s                     |
| Sound frequency       | JDW-450: 500/580 ± 20Hz<br>JDW-450-2: 500/560 ± 20Hz, Dual tone |              |                         |
| Transmission distance | 5Km   |              |                         |

JDW-300



### Features

1. Metal protective net cover can effectively prevent injuries during work.
2. The base is fixed by bolts to prevent vibration.
3. One-key start switch, simple and convenient operation.

### Parameters

|                 |             |                       |                         |
|-----------------|-------------|-----------------------|-------------------------|
| Product name    | JDW-300     | Material              | Aluminum alloy          |
| Voltage         | AC220V 50Hz | Decibel               | 125dB @ 5m              |
| Rated speed     | 2840r/min   | Package size          | 42(L) × 25(W) × 25(H)cm |
| Rated power     | 0.37kW      | Insulation class      | Level E                 |
| Net weight      | 14kg        | Transmission distance | 1.5Km                   |
| Sound frequency | 600 ± 20Hz  |                       |                         |

**LK-SCT**



**Features**

- 1.High frequency: 700HZ-1700HZ alarm sound is easy to distinguish from environmental noise, clear, harsh and sharp;
- 2.Strong compatibility  
It can be connected with smoke detectors, gas sensors, infrared sensors, liquid level sensors, timers, and various sensors of anti-theft and alarm systems;
- 3.Application  
Factories, schools, radio stations, automobiles, trains, ships, airports, ports, crossings, platforms, silver buildings, hospitals, residential areas, shopping malls, warehouses, hotels, troops, factory buildings, mining industries, port gates, etc.

**Parameters**

|                 |  |              |                                       |
|-----------------|--|--------------|---------------------------------------|
| Product name    | LK-SCT                                   | Voltage      | AC 12V / 24V / 48V / 110V / 220V      |
| Material        | ABS                                      | Decibel      | 113dB / 114dB / 115dB / 115dB / 115dB |
| Net weight      | 1.6kg                                    | Dimension    | 19.6(L) × 19.6(W) × 21(H)cm           |
| Current         | 17.4A / 8.8A / 6.2A / 1.9A / 1.0A        | Package size | 24(L) × 24(W) × 21.5(H)cm             |
| Sound frequency | 900 / 900 / 1000 / 1000 / 1000 Hz ± 50Hz |              |                                       |

**ST-SV**

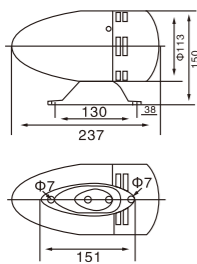

**Features**

- 1.High frequency:700HZ-1700HZ alarm sound is easy to distinguish from environmental noise, clear, harsh and sharp;
- 2.Strong:compatibilityIt can be connected with smoke detectors, gas sensors, infrared sensors, liquid level sensors, timers, and various sensors of anti-theft and alarm systems;
- 3.Application:Factories, schools, radio stations, automobiles, trains, ships, airports, ports, crossings, platforms, silver buildings, hospitals, residential areas, shopping malls, warehouses, hotels, troops, factory buildings, mining industries, port gates, etc.

**Parameters**

|                 |                                    |           |                               |
|-----------------|------------------------------------|-----------|-------------------------------|
| Product name    | ST-SV                              | Voltage   | AC 12V / 24V / 48V / 220V     |
| Current         | 17.4A / 8.8A / 6.2A / 1.0A         | Decibel   | 116dB / 117dB / 118dB / 118dB |
| Net weight      | 2kg                                | Dimension | 23.7(L) × 11.3(W) × 15(H)cm   |
| Package size    | 24(L) × 12(W) × 16(H)cm            |           |                               |
| Sound frequency | 1200 / 1200 / 1350 / 1350Hz ± 50Hz |           |                               |
| Material        | Aluminum alloy / Stainless steel   |           |                               |



# EXPLOSION-PROOF ELECTRIC SIRENS

**Features**

1. The protection level is IP55, and the explosion-proof level is Exd II BT4;
2. Special aluminum alloy material, heat treatment processing, strong moisture and corrosion resistance;
3. No jamming, no crash, no deformation, anti-wind and sand, anti-bird nesting;
4. Quick start, stable operation, strong penetrating power, and large sound coverage.

**Application**

In flammable and explosive emergency alert systems such as oil fields, chemical plants, gas stations, and oil depots.



**LK-JDW-400B**



**Parameters**

|                 |                |              |                     |
|-----------------|----------------|--------------|---------------------|
| Product name    | LK-JDW-400B    | Voltage      | 3-phase 380V        |
| Material        | Aluminum alloy | Decibel      | 123dB @ 5m          |
| Net weight      | 75kg           | Package size | 75(L)×75(W)×80(H)cm |
| Sound frequency | 500/530±20Hz   | Rated power  | 4KW                 |
| Rated speed     | 2900r/min      | Start time   | ≤3s                 |

**ST-JDW245B**



**Parameters**

|                 |                             |              |                         |
|-----------------|-----------------------------|--------------|-------------------------|
| Product name    | ST-JDW245B                  | Voltage      | 3-phase 380V            |
| Material        | Aluminum alloy              | Decibel      | 123dB @ 5m              |
| Net weight      | 39kg                        | Package size | 48(L) × 30(W) × 45(H)cm |
| Sound frequency | 500/580±20Hz                | Rated power  | 1.1KW                   |
| Rated speed     | 2900r/min                   | Start time   | ≤3s                     |
| Dimension       | 42.1(L) × 24(W) × 38.1(H)cm |              |                         |

# HAND-CRANK SIREN

**Product description**

The principle of the traditional alarm is to use a vibration sensor, once the sensor receives the vibration signal, it will automatically alarm. Hand-crank siren does not require a power source, and can provide an effective alarm in places without power support. By manually rotating the crank, it is accelerated step by step through the transmission of the gear box, and then the ringing wheel is driven to run at high speed through the transmission block. In the process of high-speed operation of the ringing wheel, the absorbed air produces high-speed and high-pressure resonance, which is simultaneously extruded to the fixed window of the fixed wheel, thereby acting as an alarm. Hand-crank siren is small in size, light in weight, easy to carry and install and does not require any tools. It only needs an area of 0.15 square meters and a place where people stand to operate normally, and the mobile operation is very strong.



**Application**

It is mostly used for emergency warning of emergencies. Its products are easy to carry, and are mainly used for flood control, disaster relief, forest fire protection, military supplies, public and industrial occasions to respond to emergency alarms.

**Use & Maintenance**

1. Only one person is required to operate the hand-crank siren to work normally. When the alarm is working, do not put fingers or other foreign objects into the ringing wheel, otherwise it will cause personal injury or damage the alarm.
2. Minors are prohibited from using hand-crank siren.
3. The sound pressure level at close range can cause permanent deafness. Therefore, always wear earmuffs to protect ears.
4. The use of sirens should comply with the "Air Defense Law" and relevant national sirens use regulations, and should be maintained regularly to keep the sirens in normal working conditions for a long time. If the alarm fails to operate normally, please seek professional repairs.

**Lifting type  
STSY-200L**



**Parameters**

|                    |  |                |                   |
|--------------------|--|----------------|-------------------|
| Product name       | STSY-200L Lifting hand crank siren                 |                |                   |
| Sound frequency    | 600 ± 20Hz   | Lifting height | 25cm (96cm~121cm) |
| Color              | Green  | Decibel        | 125 ± 2dB(A) @ 1m |
| Effective coverage | Φ2km   | Net weight     | 7kg               |
| Package size       | 22(L) × 22(W) × 25(H)cm<br>14(L) × 14(W) × 90(H)cm |                |                   |
| Material           | Aluminum alloy(Except for lifting frame)           |                |                   |

**Portable type  
ST-LK-100**



**Parameters**

|                    |                                     |            |                           |
|--------------------|-------------------------------------|------------|---------------------------|
| Product name       | ST-LK-100 Portable hand crank siren |            |                           |
| Sound frequency    | 600 ± 20Hz                          | Decibel    | 110dB(A) @ 1m             |
| Color              | Green Red                           | Net weight | 1.2kg                     |
| Effective coverage | Φ1km                                | Dimensio   | 11.5(L) × 21(W) × 24(H)cm |
| Material           | Aluminum alloy                      |            |                           |

**LK-120**



**Parameters**

|                    |                                  |            |                         |
|--------------------|----------------------------------|------------|-------------------------|
| Product name       | LK-120 Portable hand crank siren |            |                         |
| Sound frequency    | 600 ± 20Hz                       | Decibel    | 120dB(A) @ 1m           |
| Color              | Gray                             | Net weight | 8kg                     |
| Effective coverage | Φ2km                             | Dimensio   | 40(L) × 41(W) × 75(H)cm |
| Material           | Aluminum alloy                   |            |                         |

**LK-100B**



**Parameters**

|                    |                                |            |                |
|--------------------|--------------------------------|------------|----------------|
| Product name       | LK-100B Fixed hand crank siren |            |                |
| Sound frequency    | 500 ± 20Hz                     | Material   | Aluminum alloy |
| Color              | Red,green                      | Decibel    | 120dB(A) @ 1m  |
| Effective coverage | Φ1km                           | Net weight | 1.37kg         |
| Package size       | 19(L) × 17(W) × 29(H)cm        |            |                |

**ST-LK-120A**



**Parameters**

|                    |                                   |              |                               |
|--------------------|-----------------------------------|--------------|-------------------------------|
| Product name       | ST-LK-120A Fixed hand crank siren |              |                               |
| Sound frequency    | 600 ± 20Hz                        | Material     | Aluminum alloy                |
| Color              | Gray                              | Decibel      | 120dB(A) @ 1m                 |
| Effective coverage | Φ2km                              | Dimensio     | 21.2(L) × 29.4(W) × 40.2(H)cm |
| Net weight         | 5.5kg                             | Package size | 24(L) × 28(W) × 46(H)cm       |

**Fixed type  
LK-100A**



**Parameters**

|                    |                                |              |                             |
|--------------------|--------------------------------|--------------|-----------------------------|
| Product name       | LK-100A Fixed hand crank siren |              |                             |
| Sound frequency    | 500 ± 20Hz                     | Decibel      | 110dB(A) @ 1m               |
| Color              | Red,green                      | Net weight   | 1.27kg                      |
| Effective coverage | Φ500km                         | Package size | 16(L) × 15(W) × 25(H)cm     |
| Material           | Aluminum alloy                 | Dimensio     | 14(L) × 12.5(W) × 21.5(H)cm |

## ELECTRONIC BUZZER/ HORN

### Product description

BC series electronic buzzer adopts the current international advanced electronic product technology and is specially developed for hoisting machinery, door cranes and bridge cranes. The inner core of products adopts advanced special integrated circuit design, with strong anti-interference ability and stable operation; the outer shell is made of aluminum alloy die-casting, which is light in weight, waterproof, shockproof and corrosion resistant. Users can choose the tone and voice alarm mode according to their own use occasions and requirements.

### Features

1. A variety of alarm tones are available.
2. The lamp tube is made of chip light emitting diodes, with a service life of more than 100,000 hours.
3. The horn alarm is made of ABS engineering plastics, and the lampshade is made of PC material, which has particularly good impact resistance, thermal stability and gloss.
4. Special integrated chip design, super electromagnetic anti-interference performance.



### BC-3A

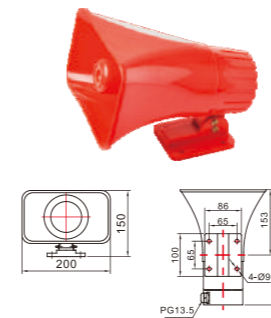

### Parameters

|                  |                         |                       |                          |
|------------------|-------------------------|-----------------------|--------------------------|
| Product name     | BC-3A Electronic buzzer | Voltage               | DC24V AC220V             |
| Power            | 10W                     | Operating temperature | -30°C ~ +70°C            |
| Humidity         | 10% ~ 90%               | Frequency             | 50/60Hz                  |
| Decibel          | 106dB(A)                | Tone                  | A / B / E / D (Optional) |
| Protection class | IP65                    | Dimension             | 20(L) × 27(W) × 15(H)cm  |
| Material         | Horn: ABS               | Net weight            | 1.5kg                    |
| Color            | Horn: Red               |                       |                          |

### BC-3B

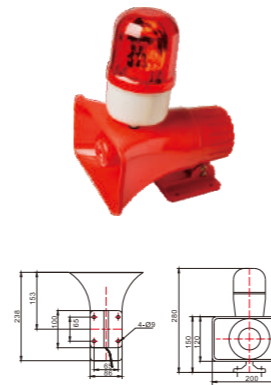

### Parameters

|                  |  |                       |  |
|------------------|--|-----------------------|--|
| Product name     | BC-3B Sound and light electronic buzzer          |                       |  |
| Power            | 10W  | Voltage               | DC24V AC220V                                 |
| Humidity         | 10% ~ 90%  | Operating temperature | -30°C ~ +70°C                                |
| Decibel          | 106dB(A)   | Frequency             | 50/60Hz                                      |
| Protection class | IP65   | Tone                  | A / B / E / D / Y / L / E / Voice (Optional) |
| Net weight       | 1.8kg  | Dimension             | 20(L) × 23.8(W) × 28(H)cm                    |
| Material         | Horn: ABS Shade: PC                              |                       |  |
| Color            | Horn: Red, White, Blue Shade: Red, Yellow, Green |                       |  |

### BC-8



### Parameters

|                  |                                |                      |   |
|------------------|--------------------------------|----------------------|---|
| Model            | BC-8                           | Power                | 6W  |
| Net weight       | 2.7kg                          | Tone                 | A/B/E/D/Y/L/F/(Voice) (Optional)                  |
| Decibel          | 106dB                          | Voltage              | DC24V, AC24V/36V / 110V / 220V / 380V(Customized) |
| Frequency        | 50/60Hz                        | Dimension            | 30(L) × 10.8(W) × 16.5(H)cm                       |
| Inlet thread     | G3/4(G")                       | Humidity             | 10%~95% (Non-condensing)                          |
| Protection class | IP65                           | Cable outer diameter | φ 8~14mm  |
| Color(Lamp)      | Red,yellow,green               | Ambient temperature  | -30°C~+70°C                                       |
| Material         | Base: Aluminum alloy Shade: PC |                      |   |

Application: Suitable for lifting equipment such as construction machinery (traveling cranes, crawler cranes, tire cranes, etc.), port machinery (gate cranes, bridge cranes, etc.).

### Selection Guide

| Model | Volume adjustable | Others   |
|-------|-------------------|--|
| D     | /                 | /  |
| A/B   | /                 | /  |
| D/B   | /                 | /  |
| D/Y   | /                 | /  |
| D/A   | /                 | /  |
| D/E   | /                 | /  |
| D     | Adjustable        | /  |
| A/B   | Adjustable        | /  |
| B/E   | Adjustable        | /  |
| D     | Adjustable        | With external switch                             |
| D     | /                 | Visible and Audible warning controlled separated |
| D     | /                 | Strobe   |

**DJ-5**

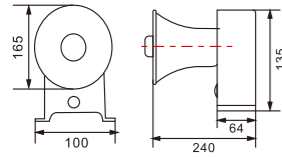

**Parameters**

|                  |                          |                       |  |
|------------------|--------------------------|-----------------------|--|
| Product name     | DJ-5 Horn alarm          | Voltage               | DC12V / 24V AC36V / 110V / 220V / 380V |
| Net weight       | 2.1kg                    | Power                 | 10W                                    |
| Decibel          | 115dB(A)                 | Material              | Base: Aluminum alloy Horn: ABS         |
| Frequency        | 50/60Hz                  | Dimension             | 17(L) × 17(W) × 24(H)cm                |
| Color            | Horn: Red                | Operating temperature | -30°C ~ +70°C                          |
| Protection class | IP65                     | Humidity              | 10% ~ 90%                              |
| Tone             | A / B / E / D (Optional) |                       |  |

Application: Suitable for lifting equipment such as construction machinery (traveling cranes, crawler cranes, tire cranes, etc.), port machinery (gate cranes, bridge cranes, etc.).

**STML-30**



**Parameters**

|                  |                       |           |                               |
|------------------|-----------------------|-----------|-------------------------------|
| Product name     | STML-30 Car megaphone |           |                               |
| Net weight       | 0.9kg                 | Power     | 30W                           |
| Decibel          | 106 ~ 140 dB(A)       | Material  | Horn: ABS                     |
| Frequency        | 50/60Hz               | Dimension | 11.8(L) × 19.5(W) × 14.6(H)cm |
| Color            | Horn: Red             | Voltage   | DC12V / 24V AC 220V           |
| Protection class | IP65                  | Tone      | A, 7 tones can be selected    |

Application: Suitable for schools, squares, factories, urban management street offices, publicity vehicles, etc.

**YH50-2TM**



**Parameters**

|                  |                        |                 |                         |
|------------------|------------------------|-----------------|-------------------------|
| Product name     | YH50-2TM Car megaphone |                 |                         |
| Net weight       | 2kg                    | Power           | 50W                     |
| Decibel          | 108 ± 3dB(A)           | Material        | Horn: Aluminium alloy   |
| Frequency        | 300~6500Hz             | Dimension       | 29(L) × 27(W) × 31(H)cm |
| Color            | Horn: Red              | Rated impedance | 8 ± 15% Ω               |
| Protection class | IP65                   |                 |                         |

Application: Suitable for schools, squares, factories, urban management street offices, publicity vehicles, etc.

**MULTI FUNCTION  
DEVICE ALARM  
BC-2**

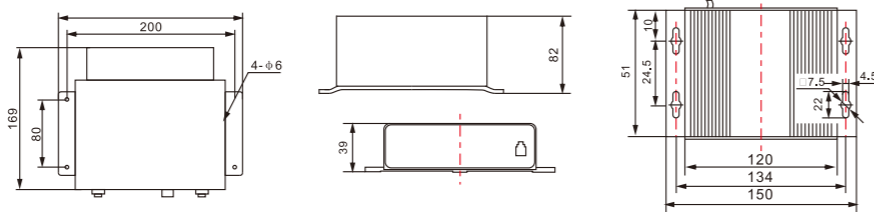

**MULTI FUNCTION  
DEVICE ALARM  
AS210**

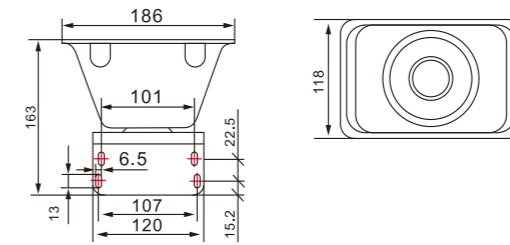

**Features**

1. Sound and light synchronous alarm (optional).
2. A variety of alarm tones are optional, and the volume is continuously adjustable.
3. With alarm delay (optional).
4. Can speak and broadcast.
5. A variety of combination configuration methods, flexible and convenient system application.

**Parameters**

|                  |   |            |            |
|------------------|---|------------|------------|
| Tone             | A / B / E can be customized   |            |            |
| Rated impedance  | 8 Ω   | Color      | Horn: Gray |
| Power            | 10 ~ 80W  | Frequency  | 300~6500Hz |
| Decibel          | 106 ~ 110dB(A)  | Net weight | 3kg        |
| Protection class | IP65  |            |            |
| Material         | Aluminum alloy, PE, cold rolled sheet   |            |            |
| Application      | Suitable for schools, squares, factories, urban management street offices, publicity vehicles, etc. |            |            |

**Selection Guide**

| Model  | Configuration |             |   |
|--------|---------------|-------------|---|
|        | MIC           | Speaker     | Tone                                    |
| BC-2B  | Handheld      | 25W/16 Ω *1 | A / B / C, Adjustable tone, alarm delay |
| BC-2C  |               | 25W/16 Ω *2 | A / B / C, Adjustable tone              |
| BC-2F  | Gooseneck     | 25W/16 Ω *1 | A / B / C, Adjustable tone              |
| BC-2Y  |               | 10W/8 Ω *1  | A / B / C, Adjustable tone, alarm delay |
| BC-2X  |               | 25W/16 Ω *2 | A / B / C, Adjustable tone              |
| BC-2K  |               | 50W/16 Ω *1 | A / B / C, Adjustable tone              |
| BC-2W  |               | 50W/16 Ω *1 | A / B / C, Adjustable tone              |
| BC-2II | Handheld      | 10W/8 Ω *1  | A / B / C, Adjustable tone, alarm delay |

| Model | Power | MIC                   | Speaker             |
|-------|-------|-----------------------|---------------------|
| As210 | 10W   | Handheld or Gooseneck | YH10-2, 10W/8 Ω     |
| AS211 | 25W   |                       | YH25-3, 25W/16 Ω    |
|       |       |                       | YH25-3, 25W/16 Ω *2 |
| As212 | 50W   |                       | YH50-3, 50W/16 Ω    |

## ML-20

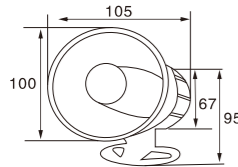

### Parameters

|                 |   |           |                           |
|-----------------|---|-----------|---------------------------|
| Rated impedance | 4 Ω   | Voltage   | DC12V/ 24V AC220V         |
| Power           | 20W   | Color     | Black                     |
| Decibel         | 120dB(A)  | Dimension | 10(L) × 10.5(W) × 13(H)cm |
| Net weight      | 1.2kg   |           |                           |
| Material        | Shell: Aluminum Alloy Base: Metal   |           |                           |
| Working mode    | Sound after power on, stop after power off  |           |                           |
| Installation    | Screw fixed, the line length is 0.3m.   |           |                           |
| Application     | Suitable for schools, squares, factories, urban management street offices, publicity vehicles, etc. |           |                           |

## Speaker



### Parameters

|                |                         |                       |                         |
|----------------|-------------------------|-----------------------|-------------------------|
| Model          | ML-687 Handheld speaker |                       |                         |
| Recording time | 12s                     | Material              | Plastic                 |
| Power          | 5W                      | Voltage               | 3.7~6v                  |
| Net weight     | 0.9kg                   | Dimension             | 35(L) × 22(W) × 19(H)cm |
| Distortion     | ≤1%                     | Transmission distance | 300m Downwind           |



### Parameters

|                |                                  |                       |                             |
|----------------|----------------------------------|-----------------------|-----------------------------|
| Model          | Handheld lithium battery speaker |                       |                             |
| Recording time | 12s                              | Material              | ABS                         |
| Power          | 30W                              | Voltage               | 3.7v                        |
| Net weight     | 0.9kg                            | Dimension             | 21.5(L) × 15(W) × 16.8(H)cm |
| Distortion     | ≤1%                              | Transmission distance | 500m Downwind               |



### Parameters

|                |   |                       |                                      |
|----------------|---|-----------------------|--------------------------------------|
| Model          | 20W / 50W Explosion-proof handheld speaker  |                       |                                      |
| Recording time | 120s  | Explosion-proof class | Exd II BT4                           |
| Power          | 20W / 50W   | Voltage               | DC12v                                |
| Net weight     | 1.3kg   | Dimension             | 20W: φ 15 × 24cm<br>50W: φ 23 × 35cm |
| Distortion     | ≤1%   | Transmission distance | 500m Downwind                        |
| Material       | ABS   |                       |                                      |
| 电池             | 8 AA dry batteries or rechargeable batteries.   |                       |                                      |
| Function       | 1. Built-in alarm, whistle and horn sound.<br>2. Support SD card, USB, AUX linear input.<br>3. Support MP3, WAV format file playback. |                       |                                      |



# STROBE LIGHT SERIES

## LTD-3101 LTD-5100 Multi strobe light

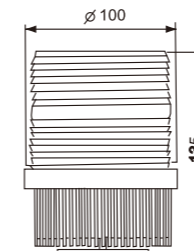

### Parameters

|                    |            |                    |                  |
|--------------------|------------|--------------------|------------------|
| Model              | LTD-3101   | Model              | LTD-5100         |
| Luminous mode      | tube light | Luminous mode      | LED light        |
| Working voltage    | DC12V      | Working voltage    | AC220V DC12V/24V |
| Police light power | 20W        | Police light power | 5W               |
| Colour             |            | Colour             |                  |

**LTD-3092  
LTD-5092  
Multi strobe light**

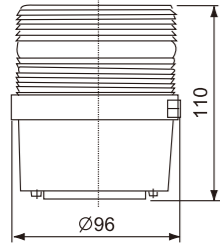

**Parameters**

| Model              | LTD-3092   | Model              | LTD-5092         |
|--------------------|------------|--------------------|------------------|
| Luminous mode      | tube light | Luminous mode      | LED light        |
| Working voltage    | DC12V      | Working voltage    | AC220V DC12V/24V |
| Police light power | 20W        | Police light power | 5W               |
| Colour             |            | Colour             |                  |

**LTD-3111  
LTD-5111  
Multi strobe light**

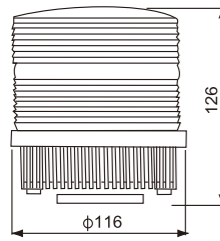

**Parameters**

| Model              | LTD-3111   | Model              | LTD-5111         |
|--------------------|------------|--------------------|------------------|
| Luminous mode      | tube light | Luminous mode      | LED light        |
| Working voltage    | DC12V      | Working voltage    | AC220V DC12V/24V |
| Police light power | 20W        | Police light power | 5W               |
| Colour             |            | Colour             |                  |

**LTD-3142  
(LTE)LTD-5142  
Multi strobe light**

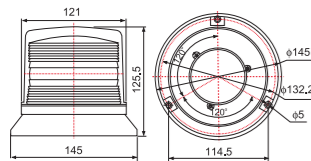

**Parameters**

| Model              | LTD-3142   | Model              | LTD-5142         |
|--------------------|------------|--------------------|------------------|
| Luminous mode      | tube light | Luminous mode      | LED light        |
| Working voltage    | DC12V      | Working voltage    | AC220V DC12V/24V |
| Police light power | 20W        | Police light power | 5W               |
| Colour             |            | Colour             |                  |

**LTD-3162  
LTD-5162  
Multi strobe light**

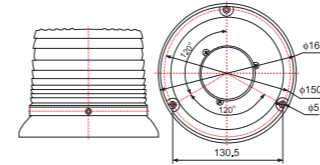

**Parameters**

| Model              | LTD-3162   | Model              | LTD-5162         |
|--------------------|------------|--------------------|------------------|
| Luminous mode      | tube light | Luminous mode      | LED light        |
| Working voltage    | DC12V      | Working voltage    | AC220V DC12V/24V |
| Police light power | 20W        | Police light power | 5W               |
| Colour             |            | Colour             |                  |

**LTD-3163  
LTD-5163  
Multi strobe light**

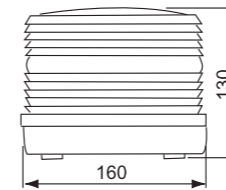

**Parameters**

| Model              | LTD-3163   | Model              | LTD-5163         |
|--------------------|------------|--------------------|------------------|
| Luminous mode      | tube light | Luminous mode      | LED light        |
| Working voltage    | DC12V      | Working voltage    | AC220V DC12V/24V |
| Police light power | 20W        | Police light power | 5W               |
| Colour             |            | Colour             |                  |

**LTD-3151  
(LTE)LTD-5151  
High-rise  
building signs**

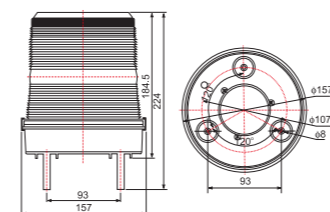

**Parameters**

| Model              | LTD-3151   | Model              | LTD-5151         |
|--------------------|------------|--------------------|------------------|
| Luminous mode      | tube light | Luminous mode      | LED light        |
| Working voltage    | DC12V      | Working voltage    | AC220V DC12V/24V |
| Police light power | 35W        | Police light power | 5W               |
| Colour             |            | Colour             |                  |

**LTE-3071  
LTE-5061  
Single strobe light**

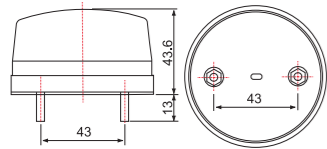

**Parameters**

|                    |            |                    |                  |
|--------------------|------------|--------------------|------------------|
| Model              | LTE-3071   | Model              | LTE-5061         |
| Luminous mode      | tube light | Luminous mode      | LED light        |
| Working voltage    | DC12V      | Working voltage    | AC220V DC12V/24V |
| Police light power | 20W        | Police light power | 5W               |
| Colour             |            | Colour             |                  |

**LTE-3072  
LTE-5072  
Dual strobe light**

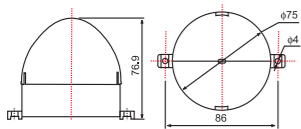

**Parameters**

|                    |            |                    |                  |
|--------------------|------------|--------------------|------------------|
| Model              | LTE-3072   | Model              | LTE-5072         |
| Luminous mode      | tube light | Luminous mode      | LED light        |
| Working voltage    | DC12V      | Working voltage    | AC220V DC12V/24V |
| Police light power | 20W        | Police light power | 2W               |
| Colour             |            | Colour             |                  |

**LTE-3051  
LTE-5051  
Single strobe light**

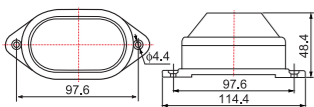

**Parameters**

|                    |            |                    |                  |
|--------------------|------------|--------------------|------------------|
| Model              | LTE-3051   | Model              | LTE-5051         |
| Luminous mode      | tube light | Luminous mode      | LED light        |
| Working voltage    | DC12V      | Working voltage    | AC220V DC12V/24V |
| Police light power | 20W        | Police light power | 2W               |
| Colour             |            | Colour             |                  |



**ROTATING WARNING LIGHT**

**LTE-1081/1081J  
(LTD)LTE-5081  
Small round**

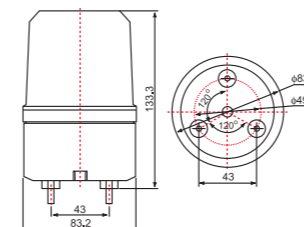

**Parameters**

|                    |                  |                    |                  |
|--------------------|------------------|--------------------|------------------|
| Model              | LTE-1081         | Model              | LTE-5081         |
| Luminous mode      | tube light       | Luminous mode      | LED light        |
| Working voltage    | AD220V DC12V/24V | Working voltage    | AD220V DC12V/24V |
| Police light power | 5W               | Police light power | 3W               |
| Colour             |                  | Colour             |                  |

**LTE-1082/  
(LTD)1082J  
LTE-5082  
Small round**

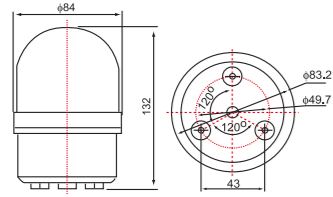

**Parameters**

| Model              | LTE-1082         | Model              | LTE-5082         |
|--------------------|------------------|--------------------|------------------|
| Luminous mode      | tube light       | Luminous mode      | LED light        |
| Working voltage    | AD220V DC12V/24V | Working voltage    | AC220V DC12V/24V |
| Police light power | 5W               | Police light power | 3W               |
| Colour             |                  | Colour             |                  |

**LTE-1083  
LTE-5083  
Small round**

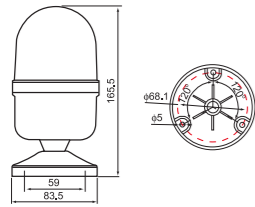

**Parameters**

| Model              | LTE-1083         | Model              | LTE-5083         |
|--------------------|------------------|--------------------|------------------|
| Luminous mode      | tube light       | Luminous mode      | LED light        |
| Working voltage    | AD220V DC12V/24V | Working voltage    | AC220V DC12V/24V |
| Police light power | 5W               | Police light power | 3W               |
| Colour             |                  | Colour             |                  |

**LTE-1084  
LTE-5084  
Small round**

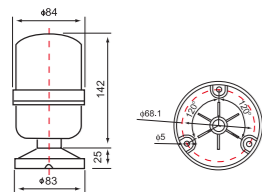

**Parameters**

| Model              | LTE-1084         | Model              | LTE-5084         |
|--------------------|------------------|--------------------|------------------|
| Luminous mode      | tube light       | Luminous mode      | LED light        |
| Working voltage    | AD220V DC12V/24V | Working voltage    | AD220V DC12V/24V |
| Police light power | 5W               | Police light power | 3W               |
| Colour             |                  | Colour             |                  |

**LTE-1101/  
(LTD)1101J  
LTE-5101  
Outer octagon**

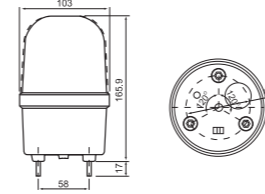

**Parameters**

| Model              | LTE-1101         | Model              | LTE-5101         |
|--------------------|------------------|--------------------|------------------|
| Luminous mode      | tube light       | Luminous mode      | LED light        |
| Working voltage    | AD220V DC12V/24V | Working voltage    | AC220V DC12V/24V |
| Police light power | 10W              | Police light power | 3W               |
| Colour             |                  | Colour             |                  |

**LTE-1102/  
(LTD)1102J  
LTE-5102  
Inner octagon**

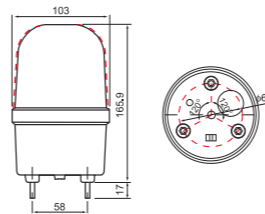

**Parameters**

| Model              | LTE-1102         | Model              | LTE-5102         |
|--------------------|------------------|--------------------|------------------|
| Luminous mode      | tube light       | Luminous mode      | LED light        |
| Working voltage    | AD220V DC12V/24V | Working voltage    | AC220V DC12V/24V |
| Police light power | 10W              | Police light power | 3W               |
| Colour             |                  | Colour             |                  |

**LTE-1103/  
(LTD)1103J  
LTE-5103  
Straight**

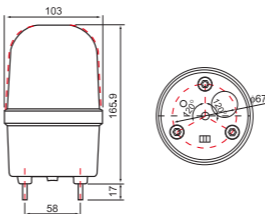

**Parameters**

| Model              | LTE-1103         | Model              | LTE-5103         |
|--------------------|------------------|--------------------|------------------|
| Luminous mode      | tube light       | Luminous mode      | LED light        |
| Working voltage    | AC220V DC12V/24V | Working voltage    | AC220V DC12V/24V |
| Police light power | 10W              | Police light power | 3W               |
| Colour             |                  | Colour             |                  |



**LTE-1104/  
(LTD)1104J  
LTE-5104  
Circular shape**

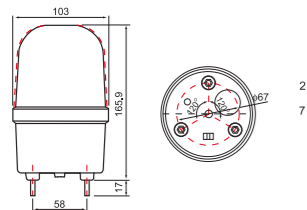

**Parameters**

| Model              | LTE-1104         | Model              | LTE-5104         |
|--------------------|------------------|--------------------|------------------|
| Luminous mode      | tube light       | Luminous mode      | LED light        |
| Working voltage    | AD220V DC12V/24V | Working voltage    | AC220V DC12V/24V |
| Police light power | 10W              | Police light power | 3W               |
| Colour             |                  | Colour             |                  |

**LTE-1121/  
(LTD)1121J  
LTE-5121/1121S  
Straight**

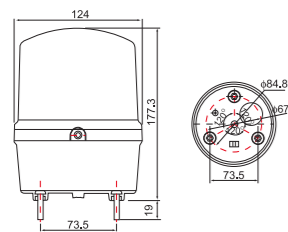

**Parameters**

| Model              | LTE-1121         | Model              | LTE-5121         |
|--------------------|------------------|--------------------|------------------|
| Luminous mode      | tube light       | Luminous mode      | LED light        |
| Working voltage    | AD220V DC12V/24V | Working voltage    | AC220V DC12V/24V |
| Police light power | 10W              | Police light power | 3W               |
| Colour             |                  | Colour             |                  |

**LTE-1161/  
(LTD)1161K  
LTE-5161  
Large straight**

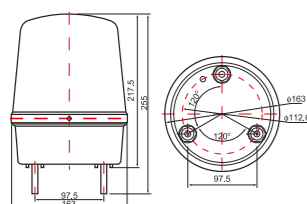

**Parameters**

| Model              | LTE-1161         | Model              | LTE-5161         |
|--------------------|------------------|--------------------|------------------|
| Luminous mode      | tube light       | Luminous mode      | LED light        |
| Working voltage    | AD220V DC12V/24V | Working voltage    | AD220V DC12V/24V |
| Police light power | 21W              | Police light power | 5W               |
| Colour             |                  | Colour             |                  |

**LTE-1181/  
(LTD)1181K  
LTE-5181  
Large round**

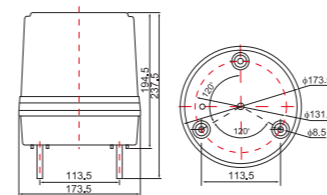

**Parameters**

| Model              | LTE-1181         | Model              | LTE-5181         |
|--------------------|------------------|--------------------|------------------|
| Luminous mode      | tube light       | Luminous mode      | LED light        |
| Working voltage    | AD220V DC12V/24V | Working voltage    | AC220V DC12V/24V |
| Police light power | 21W              | Police light power | 5W               |
| Colour             |                  | Colour             |                  |

**LTD-1201 LTD-1201K  
Snail lamp**



**Parameters**

| Model              | LTD-1201   |
|--------------------|------------|
| Luminous mode      | tube light |
| Working voltage    | DC12V/24V  |
| Police light power | 21W        |
| Colour             |            |

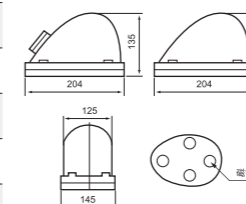

**LTE-1105  
Small bullet shape**



**Parameters**

| Model              | LTE-1105                |
|--------------------|-------------------------|
| Luminous mode      | tube light              |
| Working voltage    | AC110/220V<br>DC12V/24V |
| Police light power | 10W                     |
| Colour             |                         |

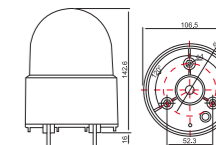

**LTE-1122 LTE-1122S  
Bullet shape**



**Parameters**

| Model              | LTE-1122                |
|--------------------|-------------------------|
| Luminous mode      | tube light              |
| Working voltage    | AC110/220V<br>DC12V/24V |
| Police light power | 10W                     |
| Colour             |                         |

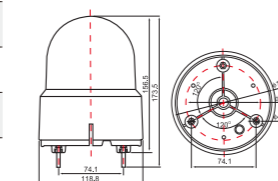

**LTD-6108  
Solar warning light**



**Parameters**

| Model              | LTD-6108  |
|--------------------|-----------|
| Luminous mode      | LED light |
| Police light power | 1W        |
| Colour             |           |

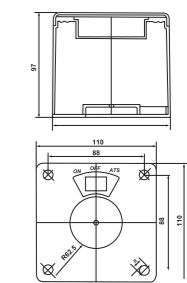



## FLASH WARNING LIGHT SERIES

**LTE-5041**  
Small round light



**Parameters**

|                    |                     |
|--------------------|---------------------|
| Model              | LTE-5041            |
| Luminous mode      | LED light           |
| Working voltage    | AC220V<br>DC12V/24V |
| Police light power | 2W                  |
| Colour             |                     |

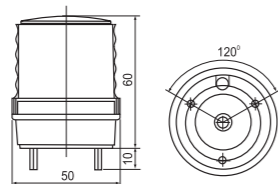

**LTD-5088 LTD-5088J**  
Vehicle fault warning light



**Parameters**

|                    |                     |
|--------------------|---------------------|
| Model              | LTD-5088            |
| Working voltage    | AC220V<br>DC12V/24V |
| Police light power | 3W                  |
| Colour             |                     |

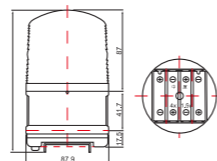

**LTE-2071/  
(LTD)2071J**  
**LTE-5071**  
Mini

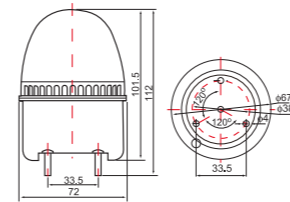

**Parameters**

|                    |                  |                    |                  |
|--------------------|------------------|--------------------|------------------|
| Model              | LTE-2071         | Model              | LTE-5071         |
| Luminous mode      | tube light       | Luminous mode      | LED light        |
| Working voltage    | AD220V DC12V/24V | Working voltage    | AC220V DC12V/24V |
| Police light power | 5W               | Police light power | 2W               |
| Colour             |                  | Colour             |                  |

**LTA-205/  
(LTD)205J**  
**LTA-505**  
Multi-layer

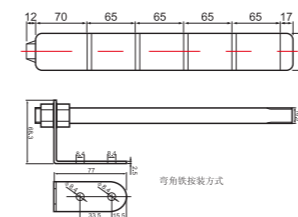

**Parameters**

|                    |                  |                    |                  |
|--------------------|------------------|--------------------|------------------|
| Model              | LTA-205          | Model              | LTA-505          |
| Luminous mode      | tube light       | Luminous mode      | LED light        |
| Working voltage    | AD220V DC12V/24V | Working voltage    | AC220V DC12V/24V |
| Police light power | 5W/节             | Police light power | 2W/节             |
| Colour             |                  | Colour             |                  |

**(LTD)LTA-204**  
**(LTD)LTA-504**  
Multi-layer



**Parameters**

|                    |                  |                    |                  |
|--------------------|------------------|--------------------|------------------|
| Model              | LTA-204          | Model              | LTA-504          |
| Luminous mode      | tube light       | Luminous mode      | LED light        |
| Working voltage    | AC220V DC12V/24V | Working voltage    | AC220V DC12V/24V |
| Police light power | 3W/节             | Police light power | 1W/节             |
| Colour             |                  | Colour             |                  |

